



Sealed Lead-Acid Battery

UPG No. 40653

UB16600

Maintenance-Free

Absorbant Glass Mat (AGM) technology for superior performance. Valve regulated, spill proof construction allows safe operation in any position. Approved for transport by air. D.O.T., I.A.T.A., F.A.A. and C.A.B. certified. U.L. recognized under file number MH 20567.



Specification

Nominal Voltage	16V (8 cells)		
Nominal Capacity	77° F (25° C)		
20-hr. (2.75A)	60 Ah		
10-hr. (5.58A)	55.8 Ah		
5-hr. (10.2A)	51.0 Ah		
1-hr. (36A)	36.0 Ah		
Approximate Weight	50.71 lbs (23.0 kgs)		
Internal Resistance (approx.)	12mΩ		
Shelf Life (% of normal capacity at 77° F (25° C))			
3 Months	6 Months	12 Months	
91%	82%	64%	
Temperature Dependency of Capacity	(20 hour rate)		
104° F	77° F	32° F	5° F
102%	100%	85%	65%

Charge Method (Constant Voltage)

Cycle Use (Repeating Use)

Initial Current	21 A or smaller
Control Voltage	19.2 - 19.6V

Float Use

Control Voltage	18.4 - 18.8V
-----------------	--------------

Physical Dimensions: in (mm)

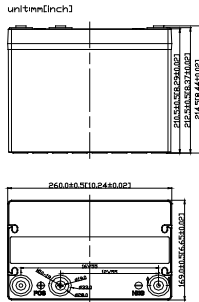

L: 10.24in (260 mm)
W: 6.65in (169 mm)
H: 8.37in (212.5 mm)
TH: 8.44in (214.5 mm)
 Tolerances are +/- 0.04 in. (+/- 1mm) and +/- 0.08 in. (+/- 2mm) for height dimensions. All data subject to change without notice.

Terminals

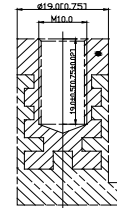

Battery Charging Characteristics for Cyclic Use

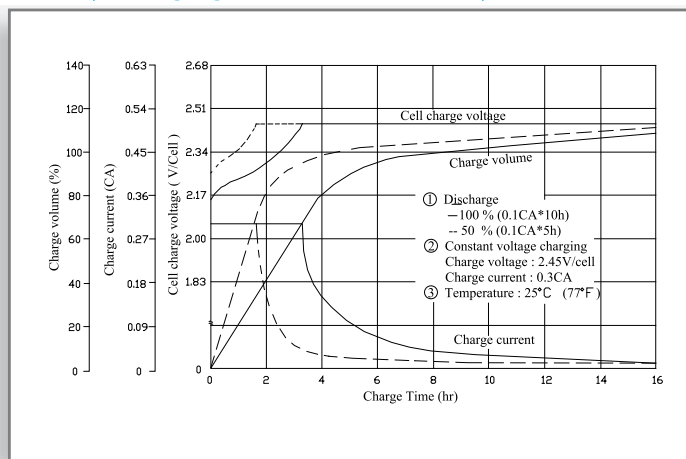

Battery Charging Characteristics for Standby Use

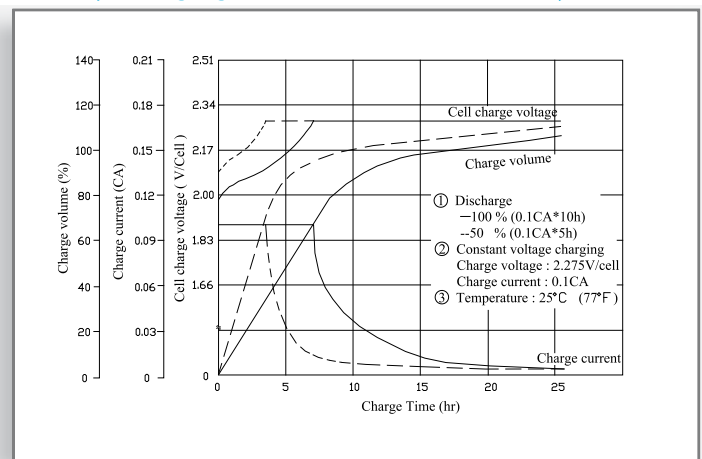

UB16600

Maintenance-Free

Discharge Time vs. Discharge Current

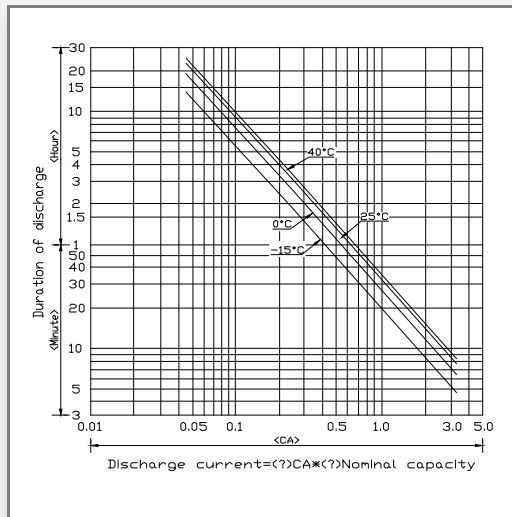

Discharge Characteristics

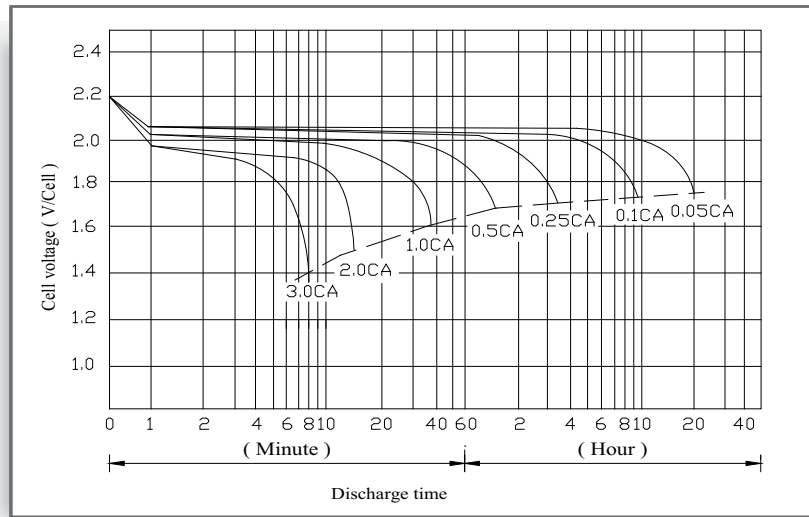

Shelf Life & Storage

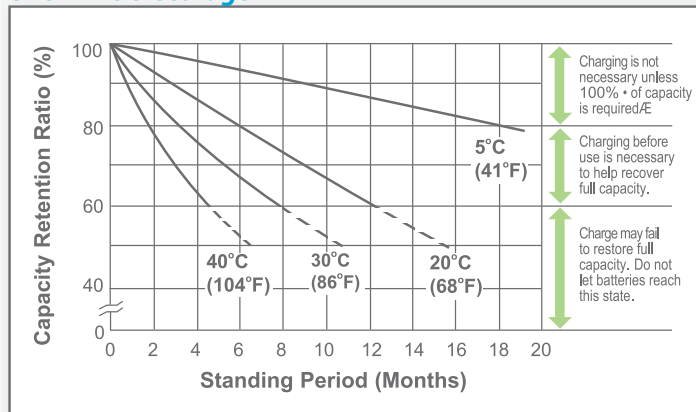

Cycle Life vs Depth of Discharge

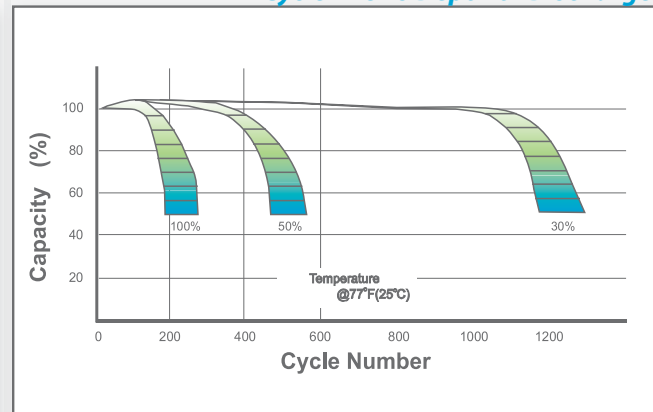

Open Circuit Voltage vs Residual Capacity

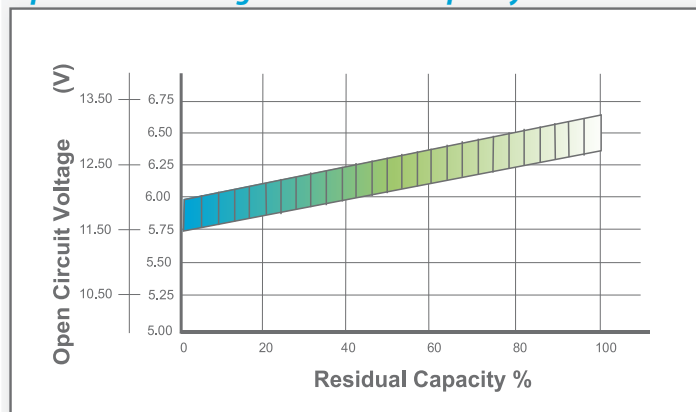

Effect of Temperature on Capacity

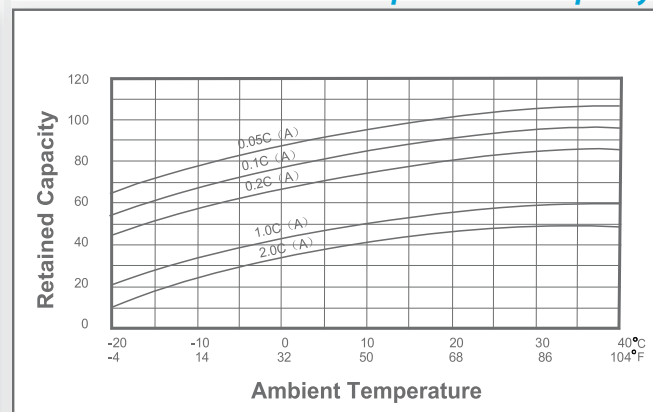

Charge Current & Final Discharge Voltage

Application	Charge Voltage(V/Cell)			Max.Charge Current	Final Discharge Voltage V/Cell	Discharge Current(A)	1.75	1.70	1.60	1.30
	Temperature	Set Point	Allowable Range							
Cycle Use	25°C(77°F)	2.45	2.40~2.50	0.35C	1.75	0.2C>(A)	1.75	1.70	1.60	1.30
Standby	25°C(77°F)	2.325	2.30~2.35		1.70	0.2C<(A)<0.5C	1.70	1.60	1.60	1.30
					1.60	0.5C<(A)<1.0C	1.60	1.60	1.60	1.30
					1.30	(A)>1.0C	1.30	1.30	1.30	1.30



ISO 9001 :2008

Let UPG Power Your Life.

www.upgi.com